



NOTES:
KEY:
 LAND TO BE ACQUIRED
 RIGHTS TO BE ACQUIRED
 CPO BOUNDARY

27339/401/2020

 Jannah
 bn

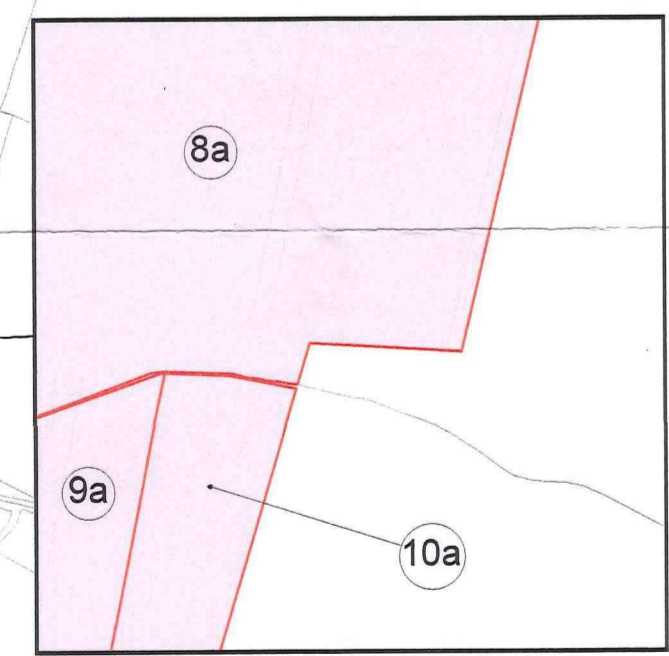
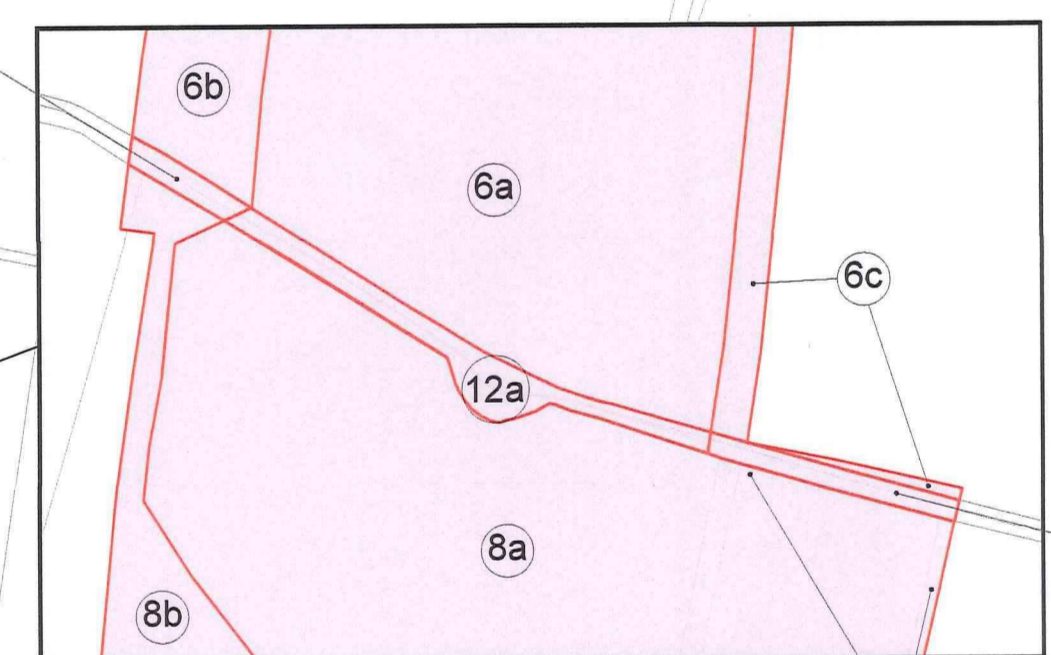
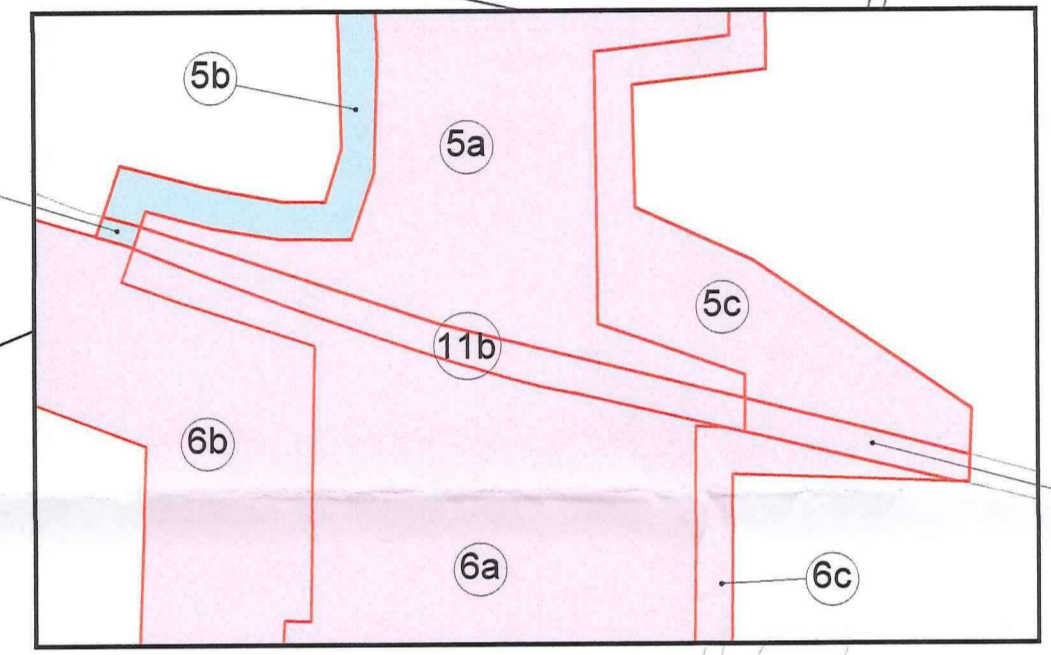
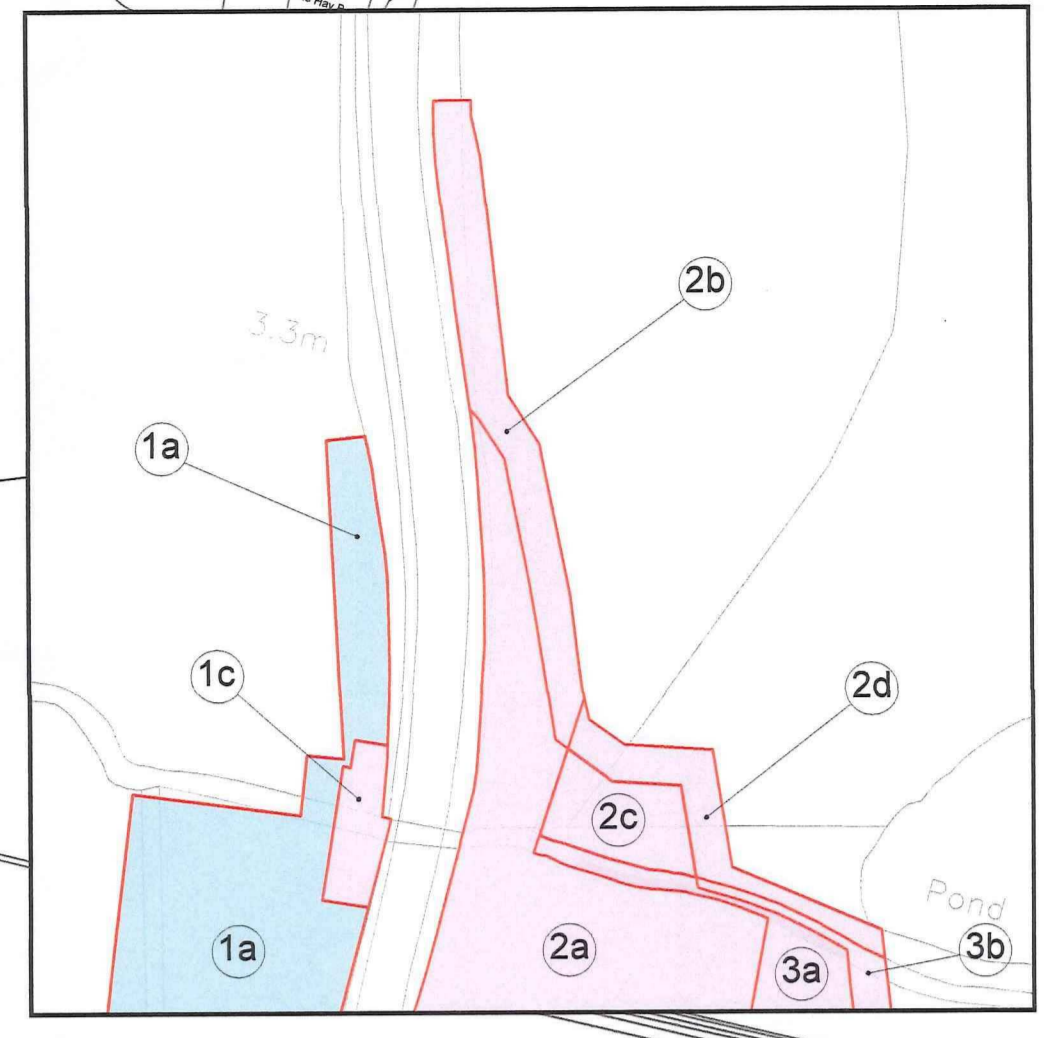

Rev	Drawn	Checked	App'd	Description	Date
P13	DPH	AJB	AJB	Parcel 6c merged with 8a, 8b & 8c renumbered 8c & 8a resp.	21-AUG-20
P12	DPH	CL	CL	Parcel 6d merged with 8b	04-AUG-20
P11	DPH	AJB	AJB	Parcel 6d merged with 8b, Parcel 6h merged with 8e	03-JUL-20
P10	DPH	AJB	AJB	Parcels 7b and 7c: Redesignated Pink	10-JUL-20
P09	DPH	AJB	AJB	Parcels 2b, 2c, 3b, 5c, 6b, 6c, 8c, 8e, 10a & 11d Redesignated Pink	07-JUL-20
P08	DPH	AJB	AJB	WISCC COMMENTS: Parcel 12 added. Molds to Parcel 1c	14-FEB-20
P05	DPH	AJB	AJB	TITLE BLOCK UPDATED	28-JAN-20
P04	DPH	AJB	AJB	WISCC COMMENTS: Parcel 12 added. Molds to Parcel 1c	15-DEC-19
P03	DPH	AJB	AJB	UPDATED FOR WISCC COMMENTS	21-JAN-20
P02	DPH	AJB	AJB	UPDATED FOR WISCC COMMENTS	15-DEC-19
P01	DPH	AJB	AJB	Minor Amendments	09-JUL-19
P00	DPH	AJB	AJB	For CPO	13-JUN-19
P00	DPH	AJB	AJB	First Issue for CPO	19-DEC-19

Purpose of Issue
For CPO
 Status
S4

Classification
Public



Project
Lymminster Bypass

Drawing
Map referred to in The West Sussex County Council (A284 Lymminster Bypass (NORTH)) Compulsory Purchase Order 2020

Scale @	Drawn	Checked	Approved
A1 1:2500	IL	AJB	AJB
A3 NTS			

Project No. CS091519 Date 22-MAY-19

Drawing Identifier A284LY-CAP-GEN-00-DR-C-0208 Project - Originator - Zone - Level - File Type - Role - Number Revision P13

CAPITA
 Highways
 Capita House, Wood Street, East Grinstead, RH19 1UU
 01342 327161
 www.capitaproperty.co.uk
 Capita Property and Infrastructure Ltd.