

**TRAFFIC REGULATION ORDER (TRO) CONSULTATION**  
**WOR9025MM – Worthing: Montague Place & Marine Parade**  
**3/4/25 – 28/4/25**

**Contents**

Notice	Page 2
Statement of Reasons	Page 3
Draft Moving Order	Page 5
Draft Parking Order	Page 7
Plan "c_worthingtq1402sen_2" - existing restrictions	Page 8
Plan "c_worthingtq1402sen_2" - proposals	Page 9
Plan "wor9025_consultation_plan" - proposals	Page 10

**West Sussex County Council**  
**(Worthing: Marine Parade (A259) And Montague Place) (Traffic Regulation)**  
**Order 2025**

**And**

**West Sussex County Council ((Worthing) (Parking Places & Traffic Regulation)**  
**(Consolidation) Order 2007) (Montague Place and Marine Parade Amendment)**  
**Order 2025**

**And**

**Worthing: Marine Place (A259) Proposed Pedestrian Crossing amendment and**  
**New Traffic Calming Feature**

NOTICE is hereby given that West Sussex County Council proposes to make two permanent Traffic regulation Order under the provisions of the Road Traffic Regulation Act 1984, the effect of which will be as follows:

The first Order extends the current 20 MPH speed limit on Marine Parade (A259) in Worthing to a point 35m west of its junction with Montague Place and includes Montague Place in the 20 MPH speed limit. The Order also prohibits driving (except for access to Beaulieu Court) on Montague Place from its junction with Marine Parade (A259) northwards to the entrance to Beaulieu Court.

The second Order removes the current loading bays on Montague Place in Worthing and replaces them with a restriction prohibiting waiting, loading and unloading at any time. The Order also installs new loading bays for any vehicle at any time on the northern side of Marine Parade (A259) either side of its junction with Montague Place. It also amends lengths of restriction prohibiting waiting, loading and unloading at any time on Marine Parade (A259) at its junction with Montague Place to accommodate alterations to a pedestrian crossing described below.

NOTICE is also hereby given that West Sussex County Council proposes to move the existing pedestrian crossing located on Marine Parade (A259) immediately west of its junction with Montague Place to a new location immediately east of its junction with Montague Place. The re-located pedestrian crossing would be installed upon a new raised traffic calming feature located on Marine Parade (A259) at its junction with Montague Place. This raised feature would be approximately 40m in length, not exceeding 65mm in height and constructed in black McAdam.

Full details of the proposals in this notice can be viewed on the Traffic Regulation Order page of the [West Sussex County Council website](#). The website includes a response form for any comments or objections.

People without access to a computer who wish to view details of the scheme should telephone the West Sussex County Council Contact Centre on 01243 642105 to receive the documents by post.

Any comments or objections about the proposal must be received before 28 April 2025. These may be submitted via the response form on the website mentioned above, by e-mail to [tro.consultation@westsussex.gov.uk](mailto:tro.consultation@westsussex.gov.uk) or in writing to TRO Team, West Sussex County Council, The Grange, Tower Street, Chichester, PO19 1RH. For legal reasons, only correspondence including a full name and address will be considered. Please quote reference WOR9025-MM in all correspondence.

Dated this 3rd day of April 2025.  
Director of Law & Assurance, County Hall, Chichester.

**West Sussex County Council**  
**(Worthing: Marine Parade (A259) And Montague Place) (Traffic Regulation)**  
**Order 2025**

**And**

**West Sussex County Council ((Worthing) (Parking Places & Traffic Regulation)**  
**(Consolidation) Order 2007) (Montague Place and Marine Parade Amendment)**  
**Order 2025**

**And**

**Worthing: Marine Place (A259) Proposed Pedestrian Crossing amendment and**  
**New Traffic Calming Feature**

**Statement of Reasons for Proposing to Make the Order**

West Sussex County Council proposes to make two permanent Traffic Regulation Orders in Worthing as follows:

The first Order extends the current 20 MPH speed limit on Marine Parade (A259) in Worthing to a point 35m west of its junction with Montague Place and includes Montague Place in the 20 MPH speed limit. The Order also prohibits driving (except for access to Beaulieu Court) on Montague Place from its junction with Marine Parade (A259) northwards to the entrance to Beaulieu Court.

The second Order removes the current loading bays on Montague Place in Worthing and replaces them with a restriction prohibiting waiting, loading and unloading at any time. The Order also installs new loading bays for any vehicle at any time on the northern side of Marine Parade (A259) either side of its junction with Montague Place. It also amends lengths of restriction prohibiting waiting, loading and unloading at any time on Marine Parade (A259), at its junction with Montague Place to accommodate alterations to a pedestrian crossing described below.

West Sussex County Council also proposes to move the existing pedestrian crossing located on Marine Parade (A259) immediately west of its junction with Montague Place to a new location immediately east of its junction with Montague Place. The re-located pedestrian crossing would be installed upon a new raised traffic calming feature located on Marine Parade (A259) at its junction with Montague Place. This raised feature would be approximately 40m in length and not exceeding 65mm in height and constructed in black McAdam.

The above measures are proposed as part of public realm improvement scheme that will install new planting and seating in Montague Place and improve pedestrian connectivity between Montague Place and Worthing Seafront.

To accommodate the new features on Montague Place, current loading bays at the southern end of the road will be relocated to new laybys on the northern side of Marine Parade (A259). Vehicular access to Montague Place will be prohibited except for vehicles using the access to Beaulieu Court.

To improve access between the new public space and Worthing seafront the existing pedestrian crossing on Marine Parade west of its junction with Montague Place is being moved to a new location east of the junction. The new location of the crossing will allow a new ramped access to be installed between Marine Parade and the seafront promenade, replacing the current steps, narrow access ramp and narrow footway at the location of the current crossing.

The crossing is to be installed on a new traffic calming feature, which along with widened footways and an extended 20 MPH speed limit, will reduce traffic speeds, improving pedestrian safety.

Further information about the project is available on Worthing Borough Council's website via the following link: [Montague Gardens in Montague Place, Worthing - Adur & Worthing Councils](#)

The new restrictions are therefore proposed to avoid danger to persons or other traffic using the affected lengths of road and to improve the amenities of the area through which the affected roads run.

The attached drawing, titled Montague Place General Arrangement shows the extended speed limit, relocated crossing and traffic calming feature. Drawing number TQ1402SEN shows the amendments to parking restrictions.

Director of Law & Assurance  
25 March 2025  
WOR9025-MM

**WEST SUSSEX COUNTY COUNCIL**  
**(WORTHING: MARINE PARADE (A259) AND MONTAGUE PLACE)**  
**(TRAFFIC REGULATION) ORDER 2025**

West Sussex County Council in exercise of their powers under Section 84 (1) a of the Road Traffic Regulation Act 1984 ("the Act"), and after consultation with the chief officer of police in accordance with Part III and Part IV of Schedule 9 to the Act hereby make the following Order:-

1. This Order shall come into operation on the \*\*\*\*\* day of \*\*\*\*\* and may be cited as "West Sussex County Council (Worthing: Marine Parade (A259) and Montague Place) (Traffic Regulation) Order 2025"
2. The Parts of Orders Specified in the First Schedule to this Order are hereby revoked.

**Speed Limit Provisions**

3. The lengths of roads specified in the Second Schedule to this Order shall not be restricted roads for the purpose of Section 82 of the Act.
4. No person shall cause or permit any vehicle to proceed at a speed exceeding 20 miles per hour in the length of road specified in the Second Schedule to this Order.
5. Nothing in Paragraphs 3 or 4 shall apply to a vehicle being used by naval, military or air force purposes while being driven by a person for the timebeing subject to the orders of a member of the armed forces of the Crown on an occasion when –  
  
(a) the person driving the vehicle is a member of the special forces as defined by the Road Traffic Exemptions (Special Forces) (Variation and Amendment) Regulations 2011; and  
  
(b) the vehicle is being driven-  
  
(i) in response, or for practice in responding, to a national security emergency by a person who has been trained in driving vehicles at high speeds; or  
  
(ii) for the purpose of training a person in driving vehicles at high speeds.

**Prohibition of Driving Provisions**

6. Save as provided by Article 7, no person shall cause or permit any motor vehicle to proceed in the length of road specified in the Third Schedule to this Order.
7. Nothing in Article 6 shall apply to a vehicle being used by the Police, Fire Brigade or Ambulance Service in the event of an emergency.
8. Save as provided by Article 9, no person shall cause or permit any vehicle to proceed in the length of road specified in the Fourth Schedule to this Order.
9. Nothing in Article 8 shall apply to:  
a) to a vehicle being used by the Police, Fire Brigade or Ambulance Service in the event of an emergency; or  
b) A vehicle belonging to a resident of, or visitor to Beaulieu Court proceeding only to gain access to the parking garage of that property

**FIRST SCHEDULE**  
**Orders to be Revoked**

<b>Order Title</b>	<b>Part of Order to be Revoked</b>
West Sussex County Council (Worthing: Marine Parade) (20 MPH Speed Limit) Order 2008	The whole Order
West Sussex County Council (Worthing: Chapel Road and Adjoining Roads) (Traffic Regulation) Order 2009	The Second Schedule, Item No.7 Marine Parade
West Sussex County Council (Worthing: Montague Place) (Prohibition of Driving) Order 2022	The whole Order

**SECOND SCHEDULE**  
**20 MPH Speed Limit**

<b>Road in Worthing</b>	<b>Length of Restriction</b>
Marine Parade (A259)	From a point 35 metres west of its junction with Montague Place eastwards to a point 10 metres east of its junction with Marine Place
Montague Place	From its junction with Marine Parade (A259) northwards to the northern side of the vehicular access to Beaulieu Court

**THIRD SCHEDULE**  
**Prohibition of Driving**

<b>Road in Worthing</b>	<b>Length of Restriction</b>
Montague Place	From the northern side of the vehicular access to Beaulieu Court, northwards to its junction with Montague Street

**FOURTH SCHEDULE**  
**Prohibition of Driving Except for Access to Beaulieu Court**

<b>Road in Worthing</b>	<b>Length of Restriction</b>
Montague Place	From its junction with Marine Parade (A259) northwards to the northern side of the vehicular access to Beaulieu Court

**For and on behalf of WEST SUSSEX COUNTY COUNCIL**

*Authorised Signatory:*

*NAME:*

*DATE MADE:*

WOR9025-MM

\*\*\*\*

**WEST SUSSEX COUNTY COUNCIL**  
**((WORTHING) (PARKING PLACES & TRAFFIC REGULATION) (CONSOLIDATION)**  
**ORDER 2007)**

**(MONTAGUE PLACE AND MARINE PARADE AMENDMENT) ORDER 2025**

West Sussex County Council in exercise of their powers under Sections 1 (a) 2 (1) and (2), 4 (2), 45. 46. 49 and 53 and Part IV of Schedule 9 of the Road Traffic Regulation Act 1984 ("the Act") as amended and of all other enabling powers and after consultation with the Chief Officer of Police in accordance with Part III of Schedule 9 to the Act hereby make the following Order:-

1. The Order shall come into operation on the \*\*\*\*\* day of \*\*\*\*\* 2025 and may be cited as "West Sussex County Council) ((Worthing) (Parking Places & Traffic Regulation) (Consolidation) Order 2007) (Montague Place and Marine Parade Amendment) Order 2025".
2. The "West Sussex County Council ((Worthing) (Parking Places & Traffic Regulation) (Consolidation) Order 2007" is hereby amended by the replacement of the plan specified in the First Schedule to this Order, with the plan specified in the Second Schedule, attached hereto.

**FIRST SCHEDULE**  
**Plan to be Replaced**

TQ1402SEN (Issue Number 12)

**SECOND SCHEDULE**  
**Replacement Plan**

TQ1402SEN (Issue Number 13)

**For and on behalf of WEST SUSSEX COUNTY COUNCIL**

*Authorised Signatory:*

NAME:

DATE MADE:

WOR9025-MM



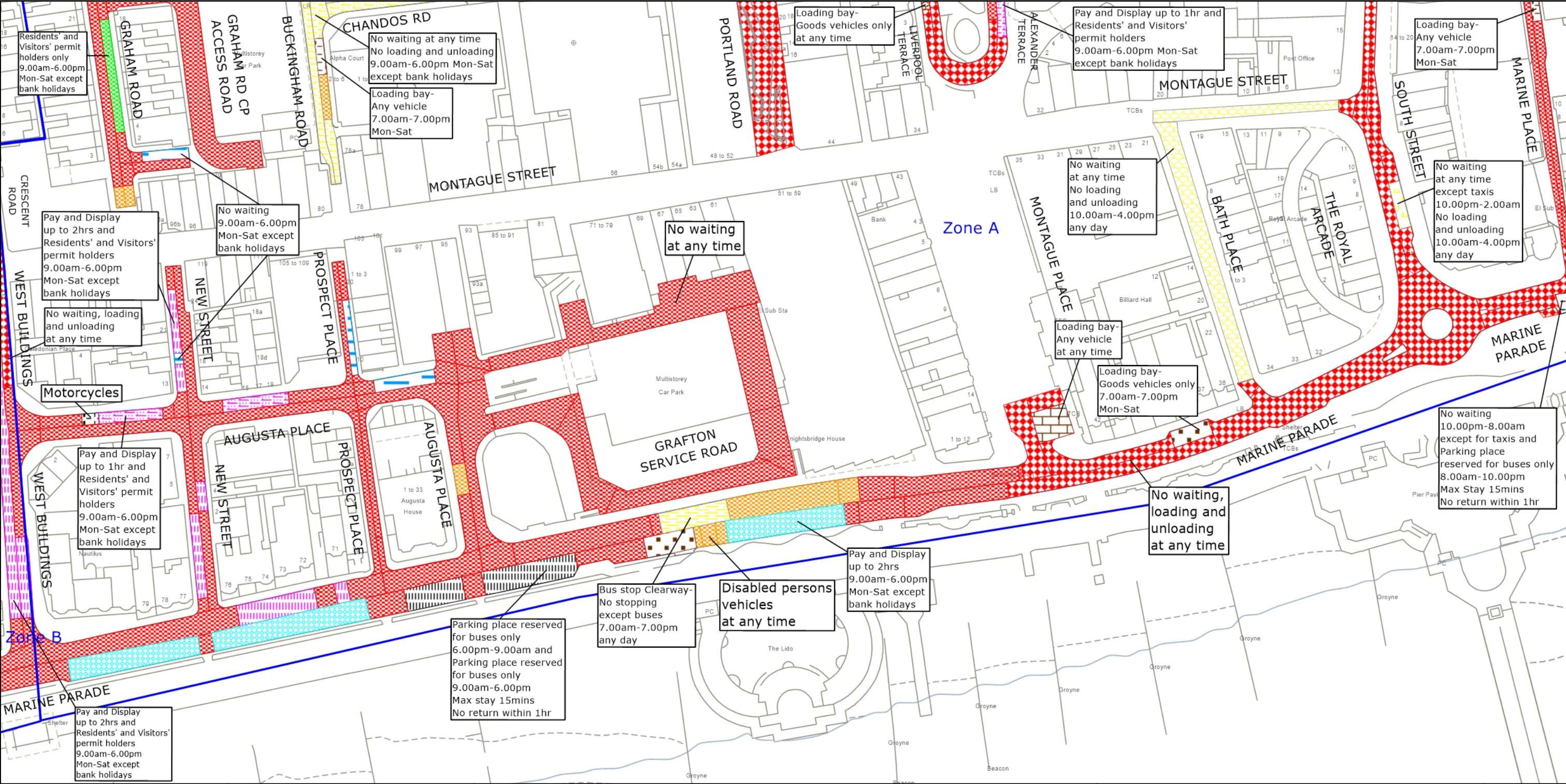



PAGE 2 OF 2: PROPOSED CHANGES TO RESTRICTIONS (CIRCLED)

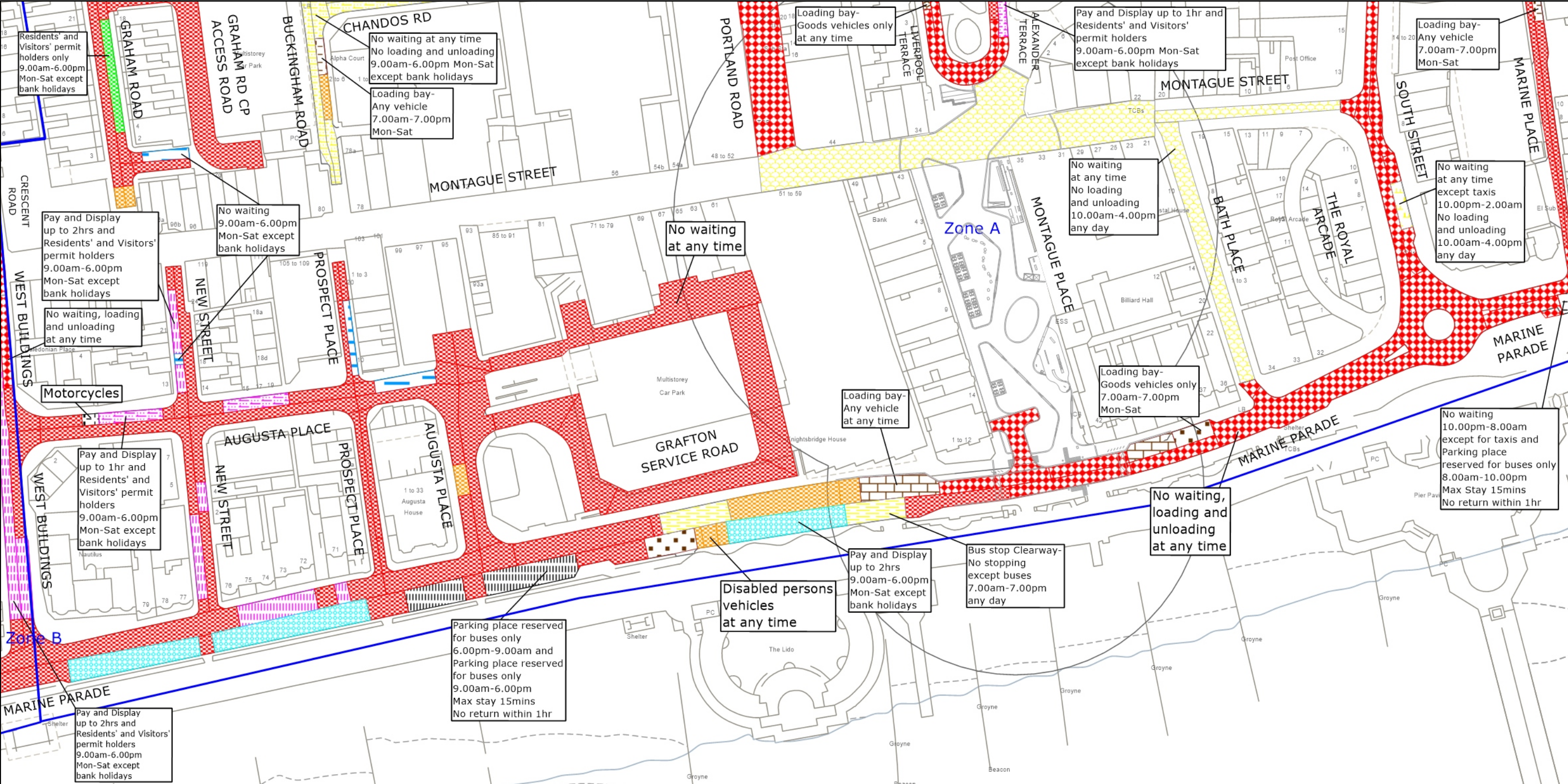





LEGEND

Hard landscape

Existing narrow clay pavers to be retained

Existing historic pavers to be reinstated

P1a - Proposed High Quality Concrete paving

P1b - Proposed High Quality Concrete paving

P1c - Proposed High Quality Concrete paving

Proposed concrete flag footway paving

Wet pour rubber safety surface (colour tbc)

Tarmac Footway

Tarmac Carriageway

Raised Tarmac Carriageway

Proposed flat top boulders. Length 600-900mm  
Height 150mm-300mm (above GL)

Proposed knee rail fencing

Soft landscape

Existing tree to be retained

Proposed trees (various types)

Proposed planting area for trees and shrubs

Proposed lawn

Features

F1

F1 - Proposed granite bench with timber top and backrest, including armrests and granite transition unit, 4 meters length

F2

F2 - Proposed granite bench with timber top and backrest, including armrests and granite transition unit, 7.7 meters length

F3

F3 - Proposed single level raised stage area

F4

F4 - Proposed Terrazzo play features to specialist manufactures details

F5

F5 - Proposed green wall structure. Cylindrical stainless steel pipe and support brackets (PC Finish) Steel rope trellis system (Jakobs or similar)

F6

F6 - Worthing branding artwork (on walls or standalone)

F7

F7- Proposed timber Kiosk and Storage shed

F8

F8 - Cycle stands

F9

F9 - Litter and recycling bins - Locations TBC

F10

F10 - Ramp access to be provided to the stage

F11

F11 - Proposed wooden telegraph poles for wind protection

F12

F12 - Proposed metal screening coloured to match brickwork back drop

F13

F13 - Proposed terrace planting to soften existing steps

F14

F14 - Proposed planter

F15

F15 - Proposed improved ramped access to promenade

Rev	Date	Description	Drm	Chk	App
2	24.10.24	UPDATED TO REFLECT DESIGN CHANGES	IC	KG	GW
1	25.09.2024	S278	SL	KG	GW
0	28.02.2024	FIRST ISSUE	ANS	KG	GW

This drawing has been specifically prepared to meet the requirements of the named client and may contain design and innovative features which differ from conventional design standards.

PROJECT  
CENTRE

www.marstonholdings.co.uk/projectcentre

Client	<div><div>WBC</div><div>WORTHING BOROUGH COUNCIL</div></div>				
Project	MONTAGUE PLACE				
Drawing Title	GENERAL ARRANGEMENT PROPOSED OVERALL SCHEME				
Drawing Status	STAGE 4				
Drawn	Designed	Date	Scale	Size	
ANS	-	FEB 24	1:250	A1	
Drawing No.	Rev				
1000007856-0100-01	2				

SAFETY, HEALTH AND ENVIRONMENTAL INFORMATION

In addition to the hazards/risks normally associated with the type of work detailed on this drawing, note the following significant risks and information identified by the designer

▲ CONSTRUCTION

C01 SGN Low Pressure Gas Valve

C02 UKPN High Voltage Lines

C03 UKPN joint box

▲ DEMOLITION

D01 Follow SWP for excavation along SGN pipes

D02 Follow SWP for excavation along UKPN HV Lines

D03 Follow SWP for excavation around UKPN Joint Box

▲ MAINTENANCE & OPERATION

— No significant hazards

It is assumed that all works will be carried out by a competent contractor working to an approved method statement.

Approved by: APPROVED - GW