

# **TRAFFIC REGULATION ORDER (TRO) CONSULTATION**

## **CHI9005RC – Chichester: Drover Lane & Acres Drive**

**22/1/26 – 12/2/26**

### **Contents**

Notice	Page 2
Statement of Reasons	Page 3
Draft Order	Page 4
Draft Speed Limit Order	Page 5
Plans – Existing & Proposed	Pages 6-12

**WEST SUSSEX COUNTY COUNCIL**  
**(CHICHESTER: ACRES DRIVE)**  
**(20MPH SPEED LIMIT) ORDER 202\***  
**&**  
**WEST SUSSEX COUNTY COUNCIL**  
**((CHICHESTER DISTRICT) (PARKING PLACES & TRAFFIC REGULATION)**  
**(CONSOLIDATION) ORDER 2010)**  
**(DROVERS LANE & ACRES DRIVE AMENDMENT) ORDER 202\***

**NOTICE** is hereby given that West Sussex County Council proposes to introduce permanent Orders under the provisions of the Road Traffic Regulation Act 1984, the effect of which will be to introduce:-

- (i) a 20mph speed limit on Acres Drive; and
- (ii) lengths of School Keep Clear prohibiting stopping at any time on both sides of Acres Drive adjacent to and opposite the entrance to Jessie Younghusband Primary School; and
- (iii) lengths of no waiting loading and unloading at any time on both sides of Acres Drive either side of the School Keep Clears; and
- (iv) lengths of prohibition of waiting at any time (double yellow lines) on Drovers Lane in and around the junctions with Acres Drive, Cornfield Way, Gobey Drive, Harris Road, Hester Road, High Meadow, Locks Farm Lane, Purchase Place and Small Meadow.

Full details of the proposals in this Notice can be viewed on our website [www.westsussex.gov.uk/tro](http://www.westsussex.gov.uk/tro). The website includes a response form for comments or objections.

Paper copies of documents will not be available to view in council offices or libraries. People without access to a computer who wish to view details of the scheme should telephone the West Sussex County Council Contact Centre on 01243 642105 to receive the documents by post.

Any objections or comments about the proposal must be received by 12 February 2026. These may be sent via the response form on the website, in writing to: TRO Team, West Sussex County Council, The Grange, Tower Street, Chichester, PO19 1RH; or by e-mail to: [tro.consultation@westsussex.gov.uk](mailto:tro.consultation@westsussex.gov.uk). All correspondence should be addressed to the undersigned, quoting the reference TRO/CHI9005/RC. Only correspondence including a full name and address will be considered.

Dated 22<sup>nd</sup> January 2026  
Executive Director of Law Assurance & Insight  
County Hall  
Chichester

.

**WEST SUSSEX COUNTY COUNCIL**  
**(CHICHESTER: ACRES DRIVE)**  
**(20MPH SPEED LIMIT) ORDER 202\***  
**&**  
**WEST SUSSEX COUNTY COUNCIL**  
**((CHICHESTER DISTRICT) (PARKING PLACES & TRAFFIC REGULATION)**  
**(CONSOLIDATION) ORDER 2010)**  
**(DROVERS LANE & ACRES DRIVE AMENDMENT) ORDER 202\***

**STATEMENT OF REASONS FOR PROPOSING TO MAKE THE ORDERS**

The County Council in exercise of their powers under the Road Traffic Regulation Act 1984, propose to make permanent Orders the effect of which will be to introduce:-

- (i) a 20mph speed limit on Acres Drive; and
- (ii) lengths of School Keep Clear prohibiting stopping at any time on both sides of Acres Drive adjacent to and opposite the entrance to Jessie Younghusband Primary School; and
- (iii) lengths of no waiting loading and unloading at any time on both sides of Acres Drive either side of the School Keep Clears; and
- (iv) lengths of prohibition of waiting at any time (double yellow lines) on Drovers Lane in and around the junctions with Acres Drive, Cornfield Way, Gobey Drive, Harris Road, Hester Road, High Meadow, Locks Farm Lane, Purchase Place and Small Meadow.

Jessie Younghusband Primary School has relocated to modern buildings at a new site on the Minerva Heights development on land west of Centurian Way and Old Broyle Road.

The school entrance is on Acres Drive accessed from the spine road Drovers Lane. It is intended to prohibit stopping along the entire length of Acres Way. In line with schools throughout West Sussex the school entrance will be protected with School Keep Clear markings. Additionally, a no waiting, loading and unloading at any time restriction will apply elsewhere on Acres Way.

It is proposed to introduce lengths of double yellow lines to protect the junctions along Drovers Lane in the vicinity of the school. This aims to prohibit parked vehicles from obscuring access and visibility.

The speed limit on Acres Way is proposed to be reduced to 20mph. This speed limit complies with the WSCC Speed Limit Policy due to the nature of the road and the large numbers of vulnerable road users using it.

The Order is proposed so as to avoid danger to persons or other traffic using the road or to minimise the likelihood of any such danger arising, for facilitating the safe passage of any class of traffic (including pedestrians) and for improving the amenity of the area through which the road runs.

Drawing CHI9005 Chichester - Acres Drive Proposed 20mph Speed Limit (10.12.2025)  
and Plan Nos. SU8405NEN SU8406SES SU8506SWS

show the lengths of roads, which are the subject of the proposed Orders.

Executive Director of Law Assurance & Insight  
County Hall  
Chichester  
December 2025

**WEST SUSSEX COUNTY COUNCIL**  
**((CHICHESTER DISTRICT) (PARKING PLACES & TRAFFIC REGULATION)**  
**(CONSOLIDATION) ORDER 2010)**  
**(DROVERS LANE & ACRES DRIVE AMENDMENT) ORDER 202\***

West Sussex County Council in exercise of their powers under Sections 1 (1) 2 (1) and (2), 4 (2), 45, 46, 49 and 53 and Part IV of Schedule 9 of the Road Traffic Regulation Act 1984 "the Act" as amended and of all other enabling powers and after consultation with the chief officer of police in accordance with Part III of Schedule 9 to the Act hereby make the following Order:-

1. This Order shall come into operation on the X day of X 2025 and may be cited as "West Sussex County Council ((Chichester District) (Parking Places and Traffic Regulation) (Consolidation) Order 2010) (Drovers Lane & Acres Drive Amendment) Order 202\*."
2. The "West Sussex County Council (Chichester District) (Parking Places and Traffic Regulation) (Consolidation) Order 2010" is hereby amended by the insertion into it of the plans attached in the First Schedule to this Order.

**FIRST SCHEDULE**  
**Plans to be inserted**  
**(As attached)**

SU8405NEN (Sheet Issue No. 1)  
SU8406SES (Sheet Issue No. 1)  
SU8506SWS (Sheet Issue No. 1)

**For and on behalf of WEST SUSSEX COUNTY COUNCIL**

***Authorised Signatory:***

***NAME:***

***DATE MADE:***



**WEST SUSSEX COUNTY COUNCIL**  
**(CHICHESTER: ACRES DRIVE)**  
**(20MPH SPEED LIMIT) ORDER 202\***

West Sussex County Council in exercise of their powers under Sections 82 and 84 (1) (a) of the Road Traffic Regulation Act 1984 ("the Act"), and Part IV of Schedule 9 of the Act and of all other enabling powers, and after consultation with the chief officer of police in accordance with Part III and Part IV of Schedule 9 to the Act hereby make the following Order:-

1. This Order shall come into operation on the x day of x 202\* and may be cited as "West Sussex County Council (Chichester: Acres Drive) (20mph Speed Limit) Order 202\*"
2. The lengths of restricted roads in the First Schedule to this Order shall cease to be restricted roads for the purpose of Section 82 of the Act.
3. No person shall cause or permit any vehicle to proceed at a speed exceeding 20 miles per hour in the lengths of roads specified in the First Schedule to this Order
4. Nothing in Paragraph 3 shall apply to a vehicle being used by naval, military or air force purposes while being driven by a person for the time being subject to the orders of a member of the armed forces of the Crown on an occasion when –
  - (a) the person driving the vehicle is a member of the special forces as defined by the Road Traffic Exemptions (Special Forces) (Variation and Amendment) Regulations 2011; and
  - (b) the vehicle is being driven-
    - (i) in response, or for practice in responding, to a national security emergency by a person who has been trained in driving vehicles at high speeds; or
    - (ii) for the purpose of training a person in driving vehicles at high speeds.

**FIRST SCHEDULE**  
**(20mph speed limit)**

Length of road in Chichester

Acres Drive

The entire length



**For and on behalf of WEST SUSSEX COUNTY COUNCIL**

*Authorised Signatory:*

*NAME:*

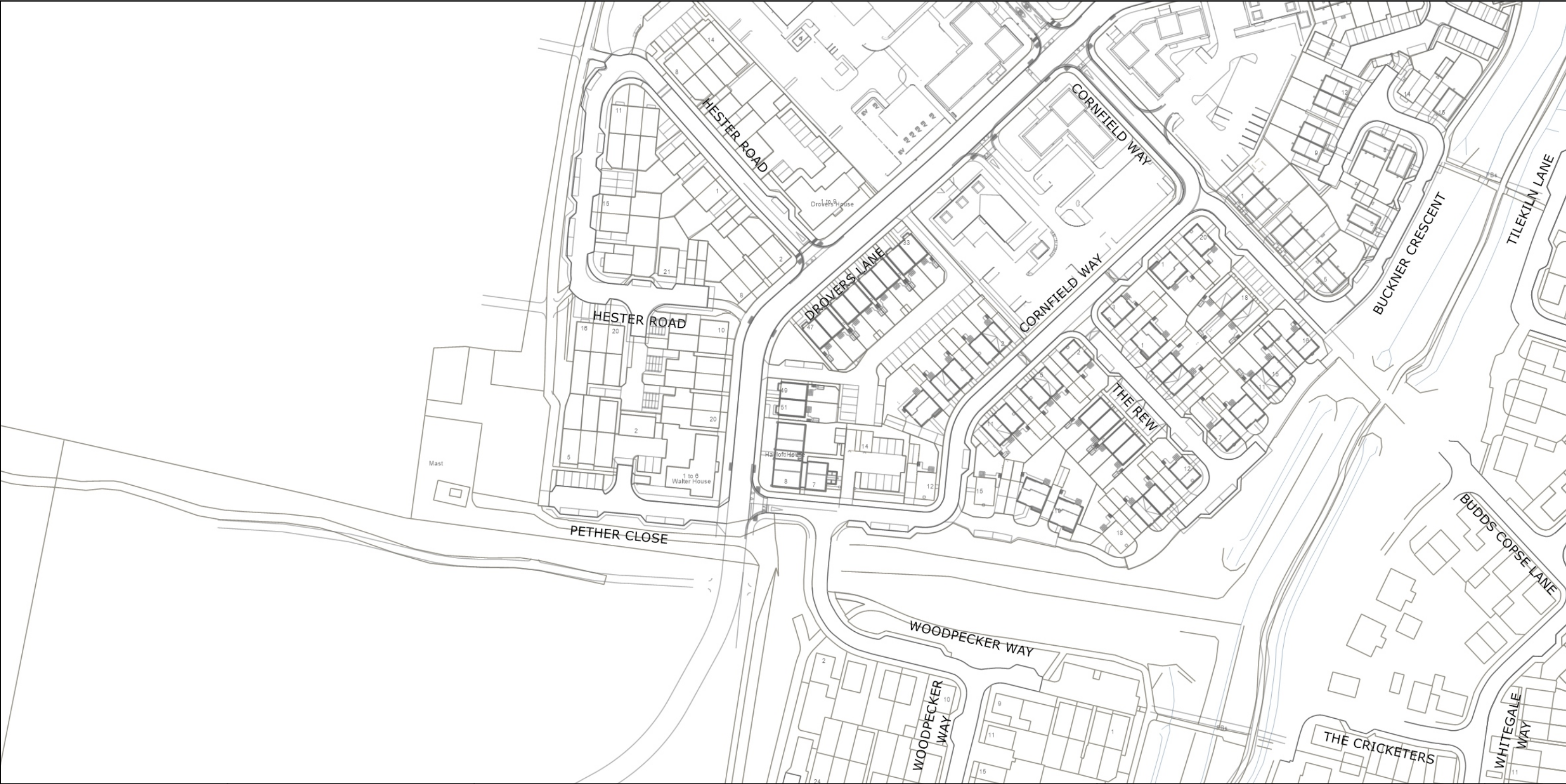
*DATE MADE:*



	<p>West Sussex County Council Highways &amp; Transport The Grange Tower Street Chichester West Sussex PO19 1RH</p>	<p>CHICHESTER DISTRICT: CHICHESTER</p> <p>NO EXISTING WAITING RESTRICTIONS</p>	<p>TILE REF NO: SU8405NEN</p> <p>SHEET ISSUE NO</p> <p>SHEET ACTIVE FROM -</p>	<p>N</p>  <p>SCALE: 1:1250 at A3 size</p>
--	--	--	--	--



© Crown copyright and database rights 2025 OS AC0000849983. You are permitted to use this data solely to enable you to respond to, or interact with, the organisation that provided you with the data. You are not permitted to copy, sub-license, distribute or sell any of this data to third parties in any form.

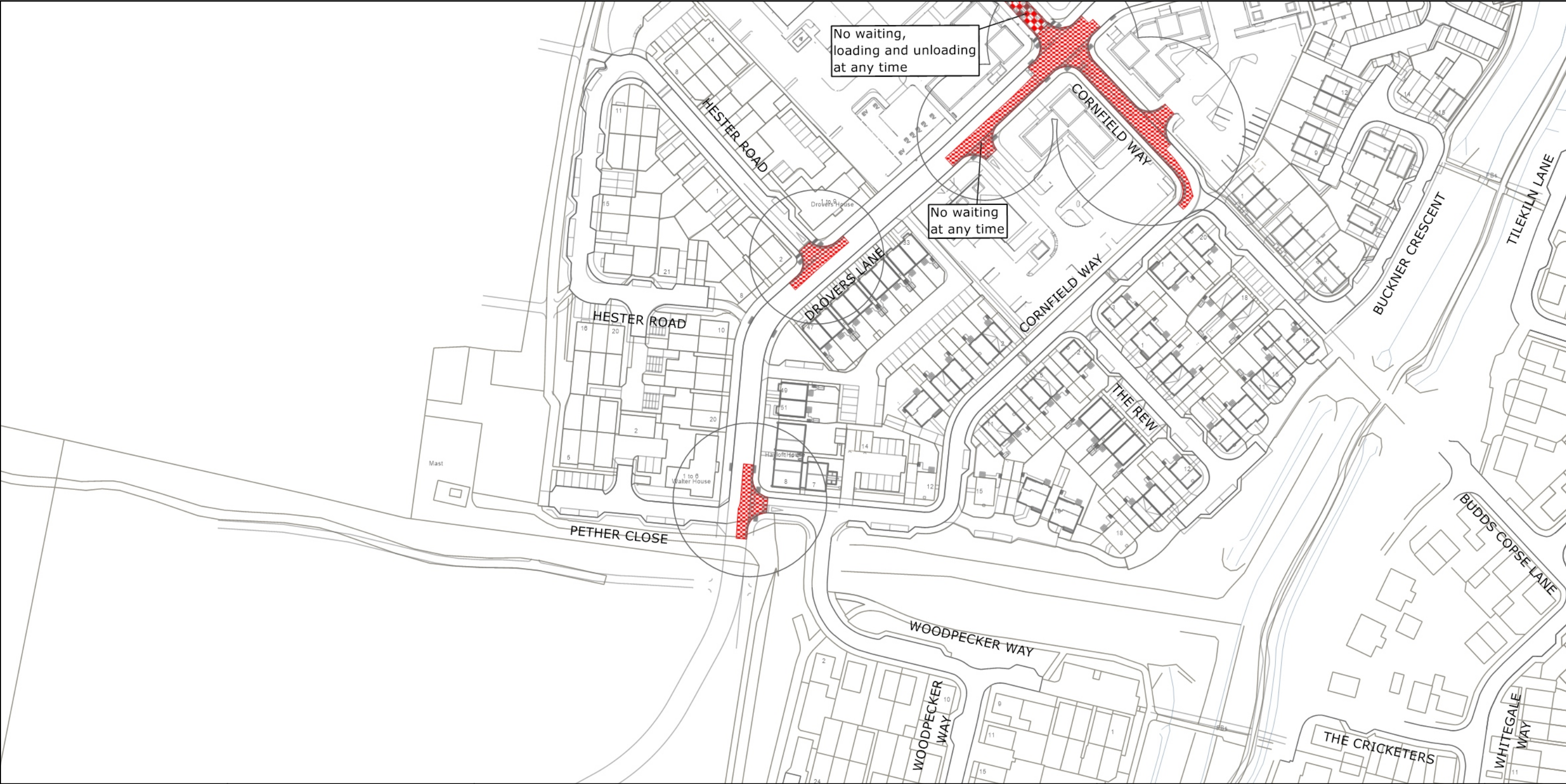



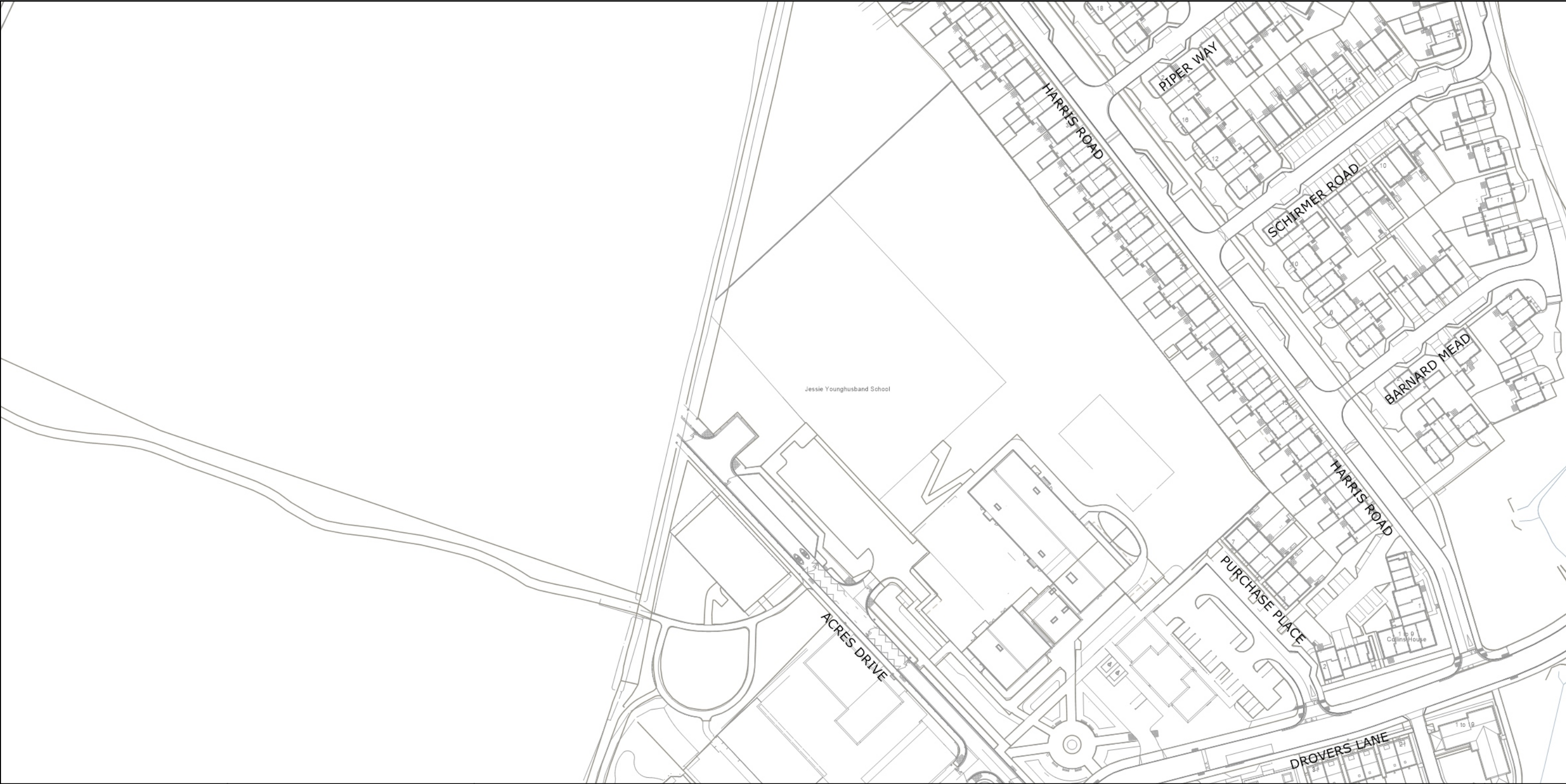



	<p>West Sussex County Council Highways &amp; Transport The Grange Tower Street Chichester West Sussex PO19 1RH</p>	<p>CHICHESTER DISTRICT: CHICHESTER</p> <p>NO EXISTING WAITING RESTRICTIONS</p>	<p>TILE REF NO: <b>SU8406SES</b></p> <p>SHEET ISSUE NO</p> <p>SHEET ACTIVE FROM -</p>	<p>N</p>  <p>SCALE: 1:1250 at A3 size</p>
--	--	--	---	--

© Crown copyright and database rights 2025 OS AC0000849983. You are permitted to use this data solely to enable you to respond to, or interact with, the organisation that provided you with the data. You are not permitted to copy, sub-license, distribute or sell any of this data to third parties in any form.



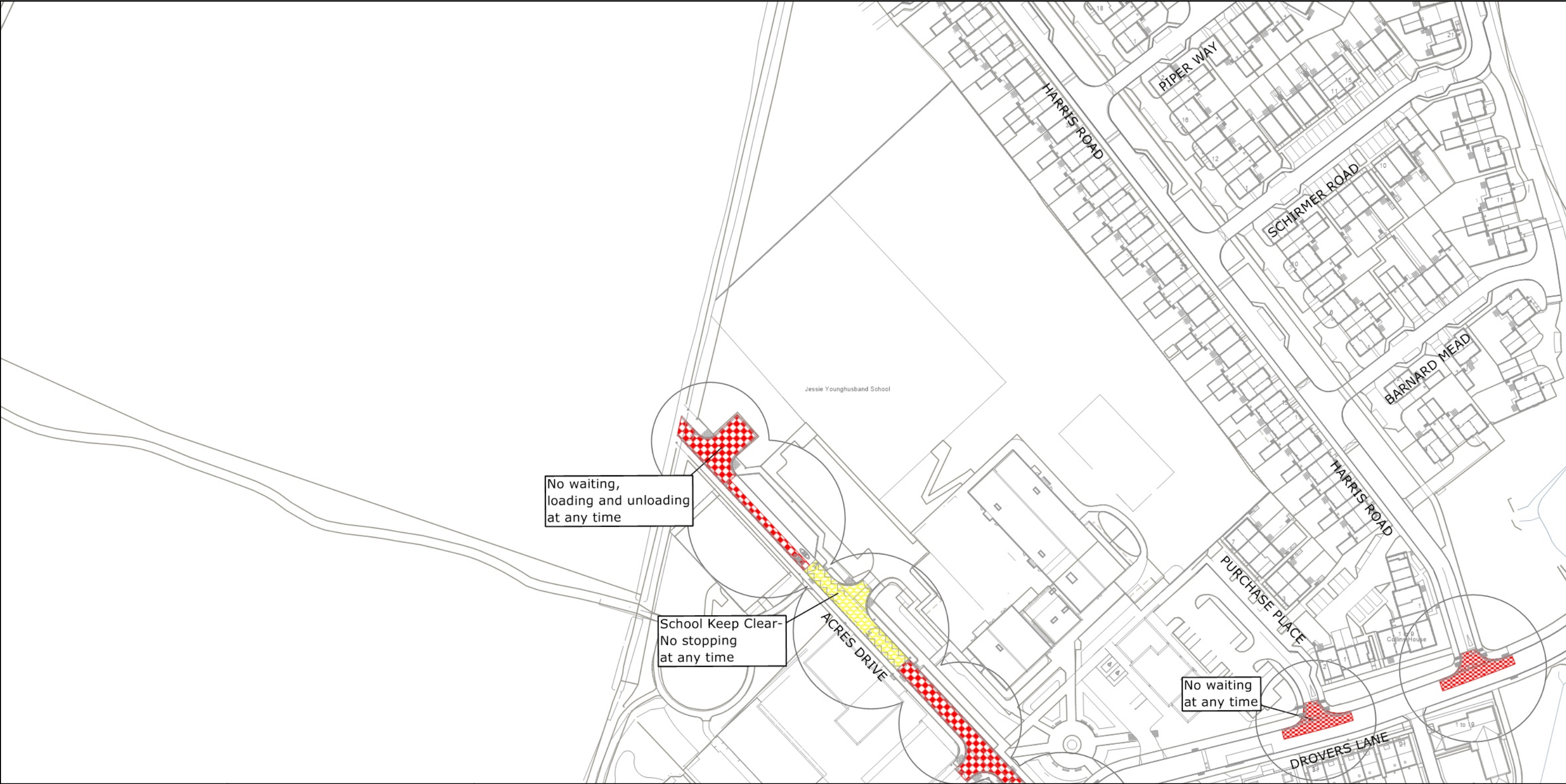



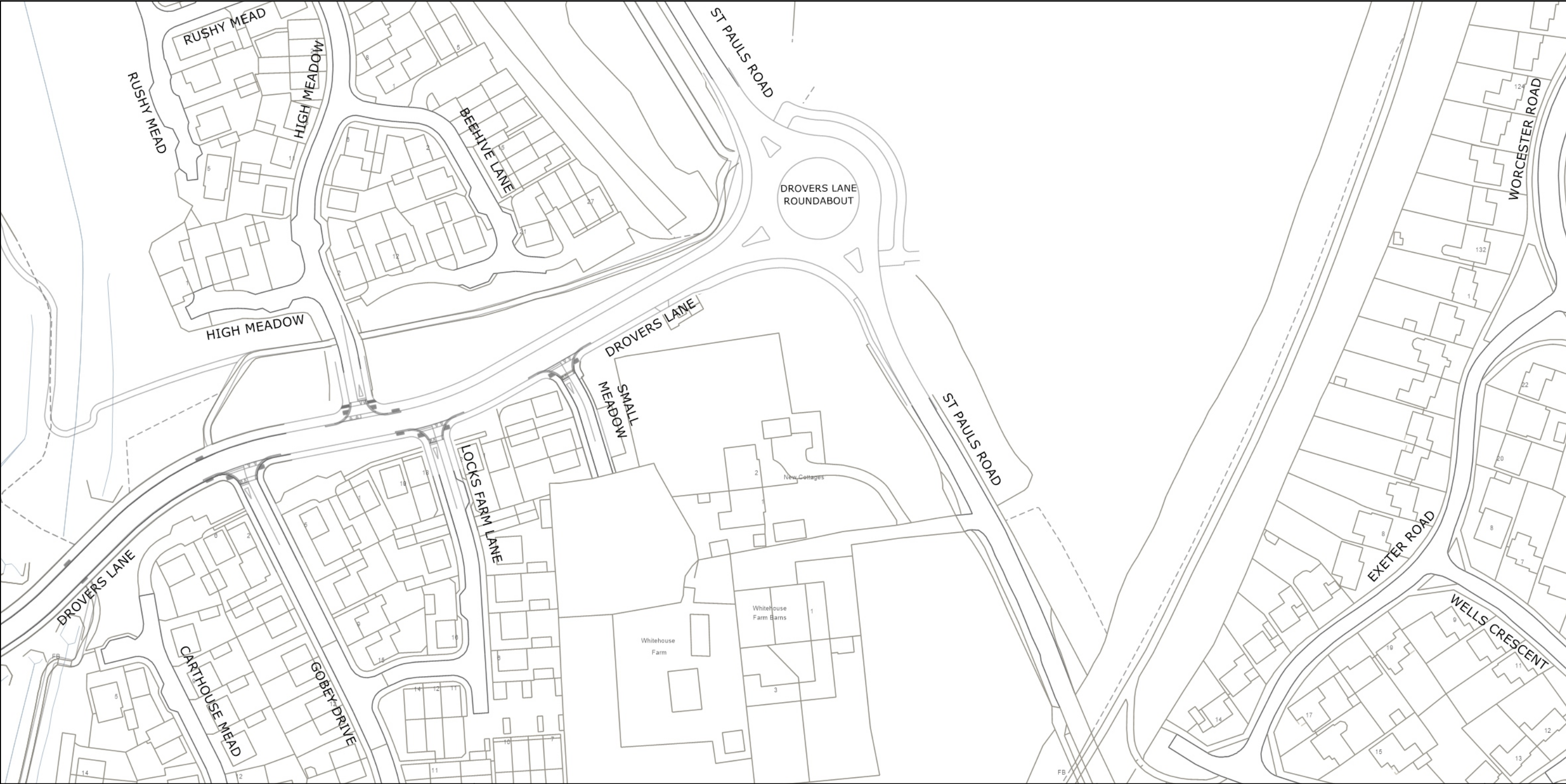



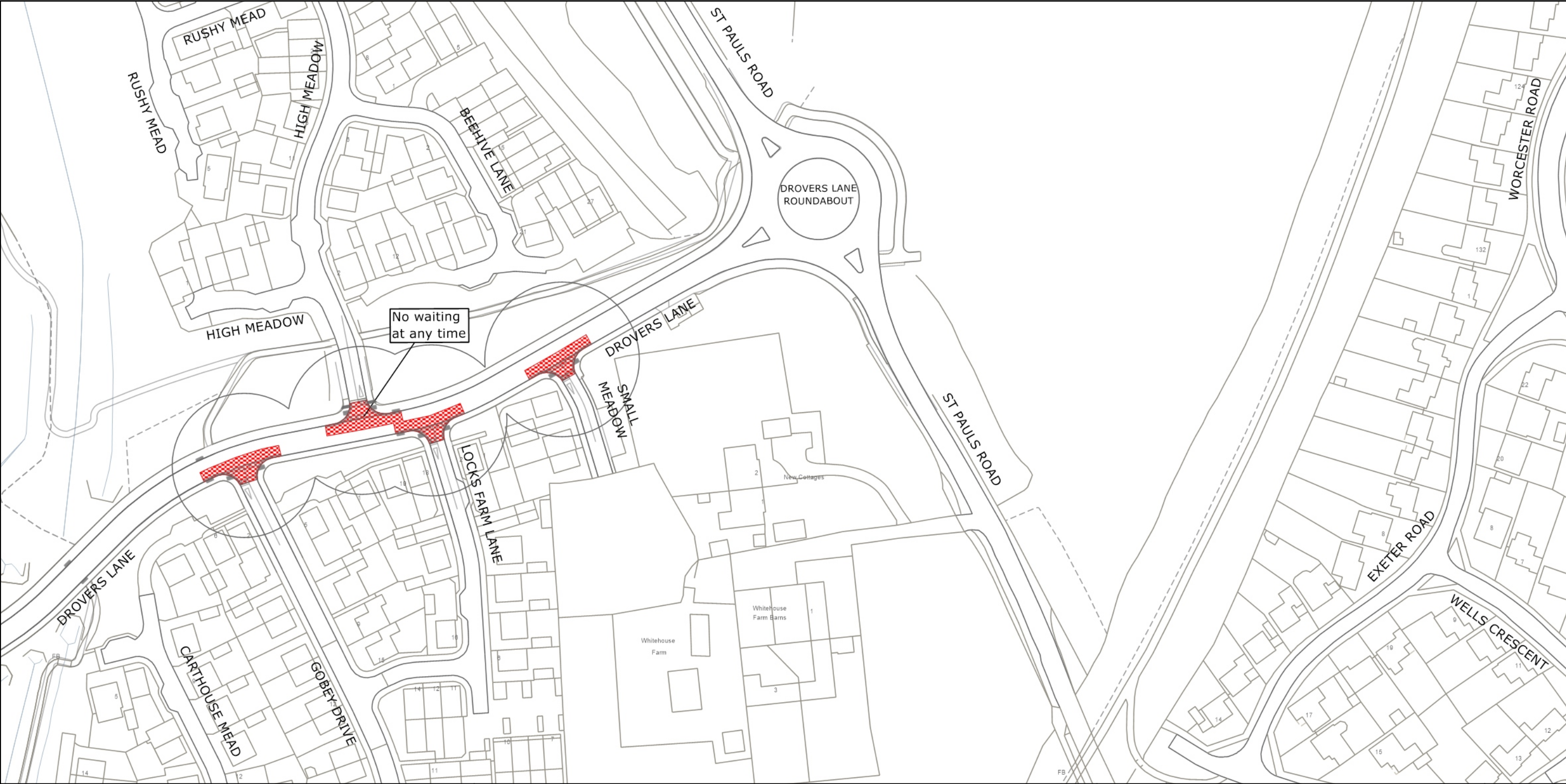





KEY

SPEED LIMITS

Proposed 20mph Speed Limit

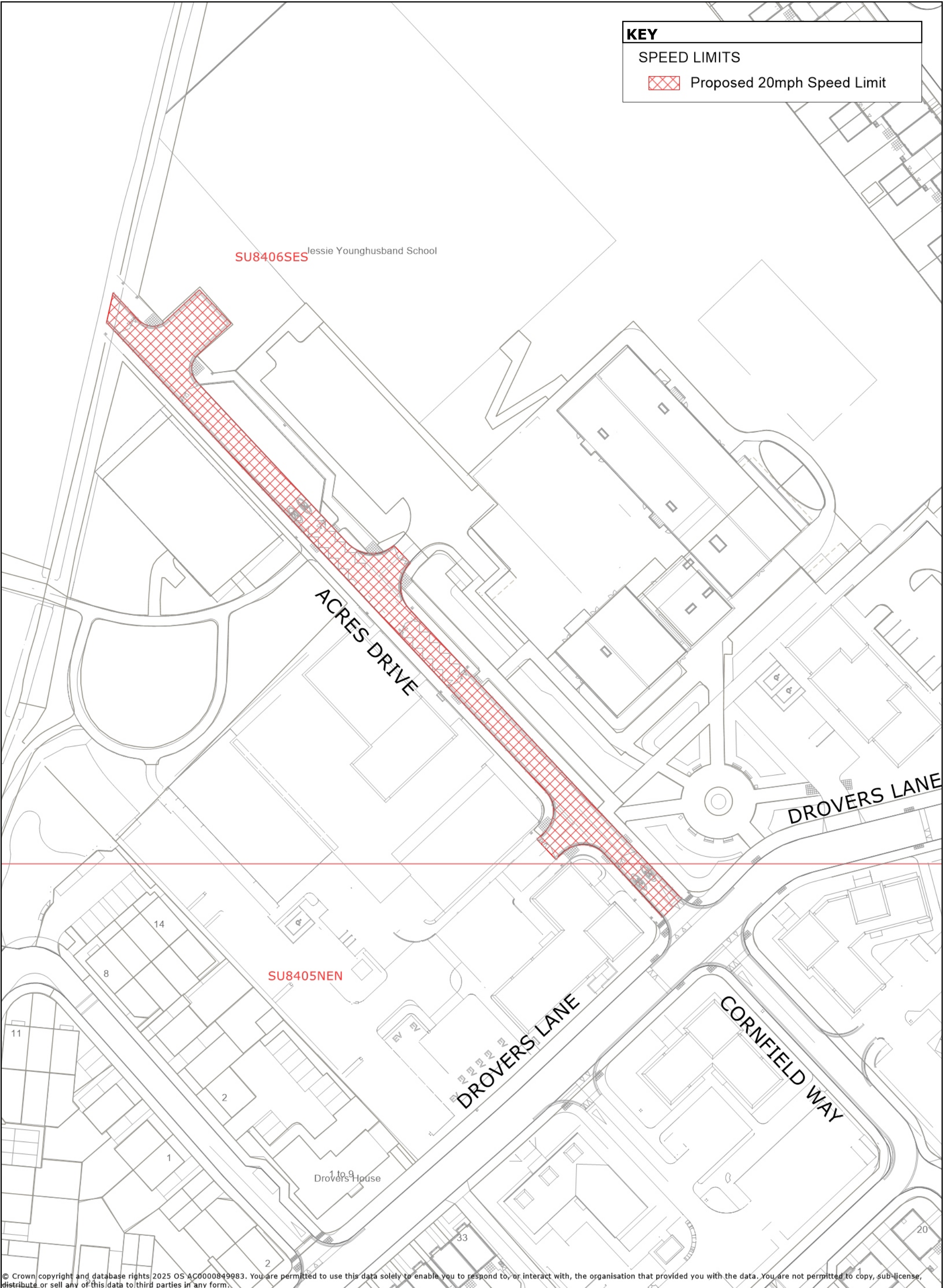

© Crown copyright and database rights 2025 OS AC0000849983. You are permitted to use this data solely to enable you to respond to, or interact with, the organisation that provided you with the data. You are not permitted to copy, sub-license, distribute or sell any of this data to third parties in any form.