

TRAFFIC REGULATION ORDER (TRO) CONSULTATION

CMS2205MM – Black Hill, Lindfield

16/3/23 – 6/4/23

Contents

Notice	Page 2
Statement of Reasons	Page 3
Draft Order	Page 4
Plan "c_midsussex tq3425ses" - existing restrictions	Page 5
Plan "c_midsussex tq3425ses" - proposals	Page 6
Plan "c_midsussex tq3425swn" - existing restrictions	Page 7
Plan "c_midsussex tq3425swn" - proposals	Page 8
Plan "c_midsussex tq3425swn" - existing restrictions	Page 9
Plan "c_midsussex tq3425swn" - proposals	Page 10

West Sussex County Council
((Mid Sussex District) (Parking Places & Traffic Regulation) (Consolidation
No.2) Order 2006)
(Lindfield: Black Hill Amendment) Order 2023

NOTICE is hereby given that West Sussex County Council proposes to make a permanent Traffic regulation Order under the provisions of the Road Traffic Regulation Act 1984, the effect of which will be to prohibit waiting at any time (introduce double yellow lines) on both sides of Black Hill in Lindfield, from its junction with Blackthorns Lane, westwards to its junction with Hickmans Lane.

Full details of the proposals in this notice can be viewed on the Traffic Regulation Order page of the [West Sussex County Council website](#). The website includes a response form for any comments or objections.

People without access to a computer who wish to view details of the scheme should telephone the West Sussex County Council Contact Centre on 01243 642105 to receive the documents by post.

Any comments or objections about the proposal must be received before 6 April 2023. These may be submitted via the response form on the website mentioned above, by e-mail to tro.consultation@westsussex.gov.uk or in writing to TRO Team, West Sussex County Council, The Grange, Tower Street, Chichester, PO19 1RH. For legal reasons, only correspondence including a full name and address will be considered. Please quote reference CMS2205-MM in all correspondence.

Dated this 16th day of March 2023.
Director of Law & Assurance, County Hall, Chichester.

West Sussex County Council
((Mid Sussex District) (Parking Places & Traffic Regulation) (Consolidation
No.2) Order 2006)

(Lindfield: Black Hill Amendment) Order 2023

Statement of Reasons for Proposing to Make the Order

West Sussex County Council proposes to make a permanent Traffic Regulation Order that will prohibit waiting on both sides of Black Hill in Lindfield, from its junction with Blackthorns Lane, westwards to its junction with Hickmans Lane.

The proposed restrictions have been applied for by Lindfield Primary School and Lindfield Parish Council, who have raised concerns that at school pick up and drop off times a high volume of parents' vehicles parking on the road obstructs the passage of other traffic along Black Hill, which is part of the B2028. It is also reported that parents' vehicles are often parked on verges causing damage, and that children have been observed opening car doors and exiting vehicles onto the carriageway of the B2028, which is hazardous for themselves and passing traffic. The new restrictions are therefore proposed to resolve these issues by moving school parking to other safer locations nearby.

The new order is therefore proposed to avoid danger to persons or other traffic using the affected lengths of road and to facilitate the passage of traffic.

The attached drawings, numbered TQ3425SES, TQ3425SWN and TQ3425SWS show the lengths of roads affected by the proposed order.

Director of Law & Assurance
27 January 2023
CMS2205-MM

WEST SUSSEX COUNTY COUNCIL
((MID SUSSEX DISTRICT) (PARKING PLACES & TRAFFIC REGULATION)
(CONSOLIDATION NO.2) ORDER 2006)

(LINDFIELD: BLACK HILL AMENDMENT) ORDER 2023

West Sussex County Council in exercise of their powers under Sections 1 (a) 2 (1) and (2), 4 (2), 45. 46. 49 and 53 and Part IV of Schedule 9 of the Road Traffic Regulation Act 1984 ("the Act") as amended and of all other enabling powers and after consultation with the Chief Officer of Police in accordance with Part III of Schedule 9 to the Act hereby make the following Order:-

1. The Order shall come into operation on the ***** day of ***** 2023 and may be cited as "West Sussex County Council ((Arun District) (Parking Places & Traffic Regulation) (Consolidation No.2) Order 2006) (Lindfield: Black Hill Amendment) Order 2023".
2. The "West Sussex County Council ((Arun District) (Parking Places & Traffic Regulation) (Consolidation No.2) Order 2006" is hereby amended by the replacement of the plans specified in the First Schedule to this Order, with the plans specified in the Second Schedule, attached hereto.

FIRST SCHEDULE
Plans to be Replaced

TQ3425SES (Issue Number 4)
TQ3425SWN (Issue Number 2)
TQ3425SWS (Issue Number 2)

SECOND SCHEDULE
Replacement Plans

TQ3425SES (Issue Number 5)
TQ3425SWN (Issue Number 3)
TQ3425SWS (Issue Number 3)

For and on behalf of WEST SUSSEX COUNTY COUNCIL

Authorised Signatory:

NAME:

DATE MADE:
CMS2205-MM

PAGE 1 OF 2: EXISTING RESTRICTIONS ONLY

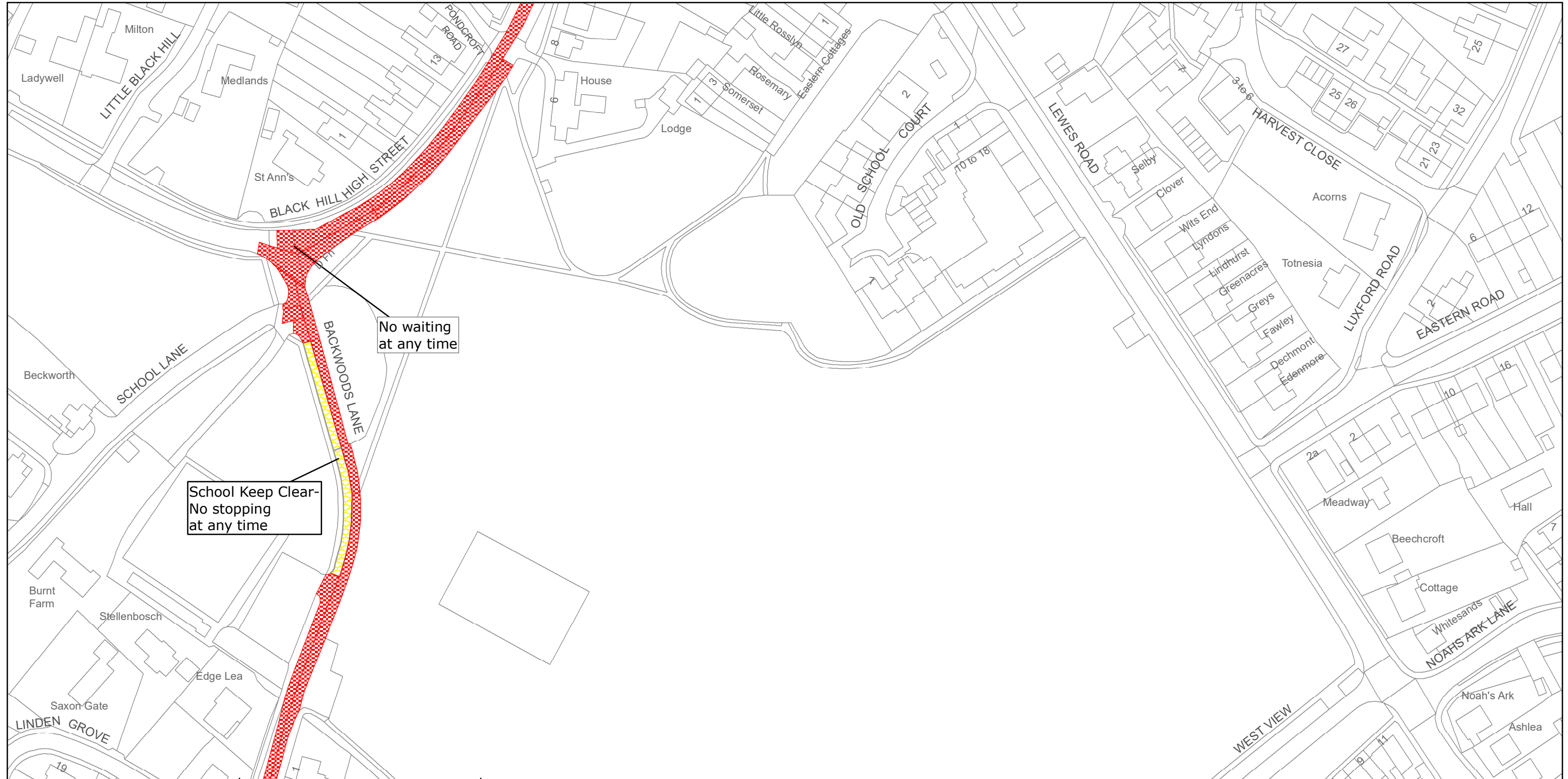

West Sussex County Council
Highways & Transport
The Grange
Tower Street
Chichester
West Sussex
PO19 1RH

MID SUSSEX DISTRICT: LINDFIELD
WAITING RESTRICTIONS

TILE REF NO:
TQ3425SES

SHEET ISSUE NO 4
SHEET ACTIVE FROM - 12/10/2015



SCALE:
1:1250

at A3 size

Reproduced from or based upon 2013 Ordnance Survey material with permission of the Controller of HMSO (c) Crown Copyright reserved.
Unauthorised reproduction infringes Crown copyright and may lead to prosecution or civil proceedings West Sussex County Council Licence No. 100023447

PAGE 2 OF 2: PROPOSED CHANGES TO RESTRICTIONS (CIRCLED)

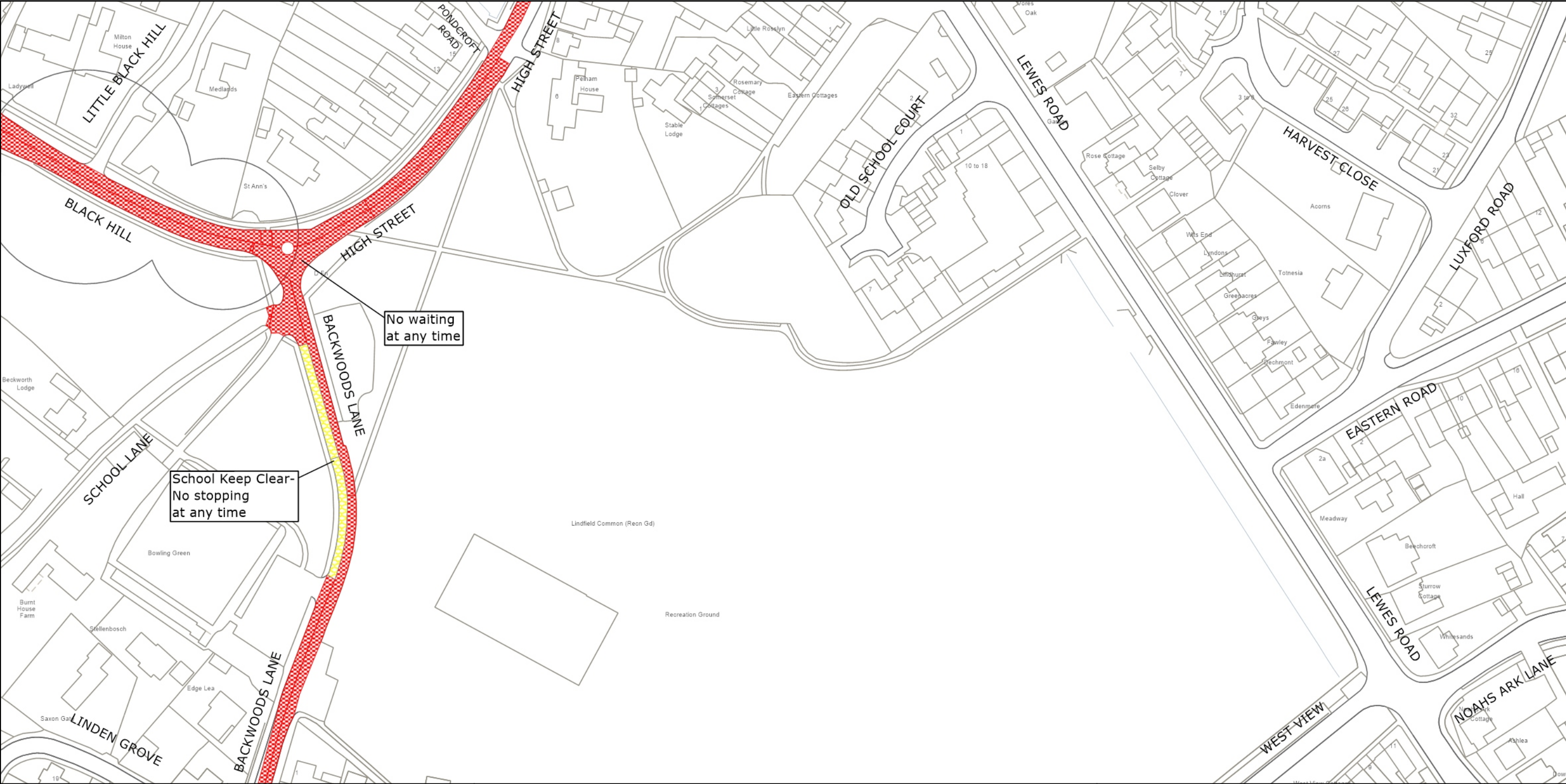

West Sussex County Council
 Highways & Transport
 The Grange
 Tower Street
 Chichester
 West Sussex
 PO19 1RH

MID SUSSEX DISTRICT: LINDFIELD
 PROPOSED WAITING RESTRICTIONS (20.01.2023)

TILE REF NO:
 TQ3425SES
 SHEET ISSUE NO 5_CMS2205
 SHEET ACTIVE FROM - DD.MM.YYYY

N

 SCALE:
 1:1250
 at A3 size

Reproduced from or based upon 2023 Ordnance Survey mapping with permission of the Controller of HMSO (c) Crown Copyright reserved. Unauthorised reproduction infringes Crown copyright and may lead to prosecution or civil proceedings West Sussex County Council Licence No. 100018485

PAGE 1 OF 2: EXISTING RESTRICTIONS ONLY

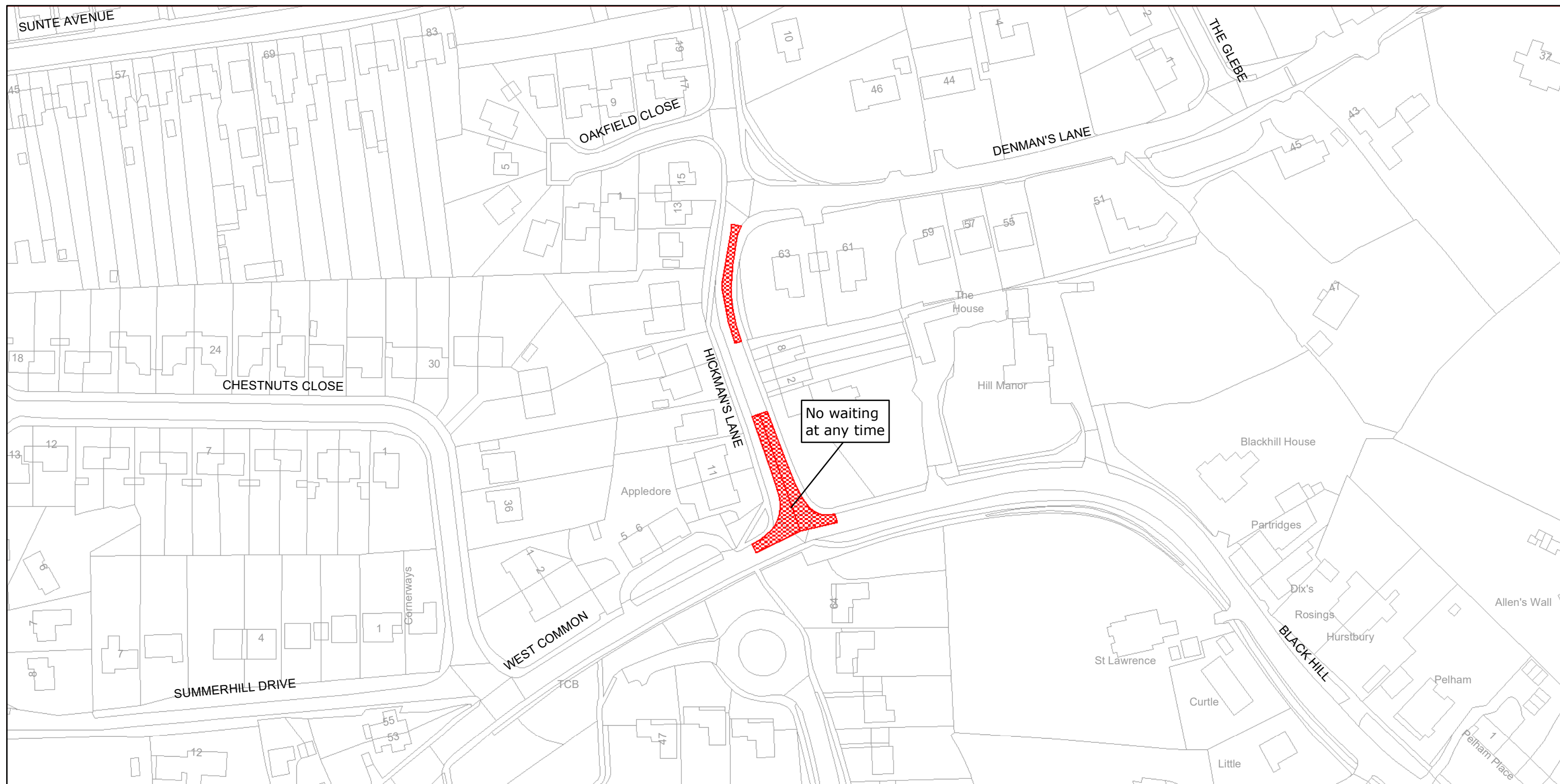

West Sussex County Council
Highways & Transport
The Grange
Tower Street
Chichester
West Sussex
PO19 1RH

MID SUSSEX DISTRICT: LINDFIELD
WAITING RESTRICTIONS

TILE REF NO:
TQ3425SWN

SHEET ISSUE NO 2
SHEET ACTIVE FROM - 23/08/2006

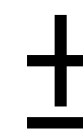

SCALE:
1:1250
at A3 size

Reproduced from or based upon 2006 Ordnance Survey mapping with permission of the Controller of HMSO (c) Crown Copyright reserved.
Unauthorised reproduction infringes Crown copyright and may lead to prosecution or civil proceedings West Sussex County Council Licence No. 100018485

PAGE 2 OF 2: PROPOSED CHANGES TO RESTRICTIONS (CIRCLED)

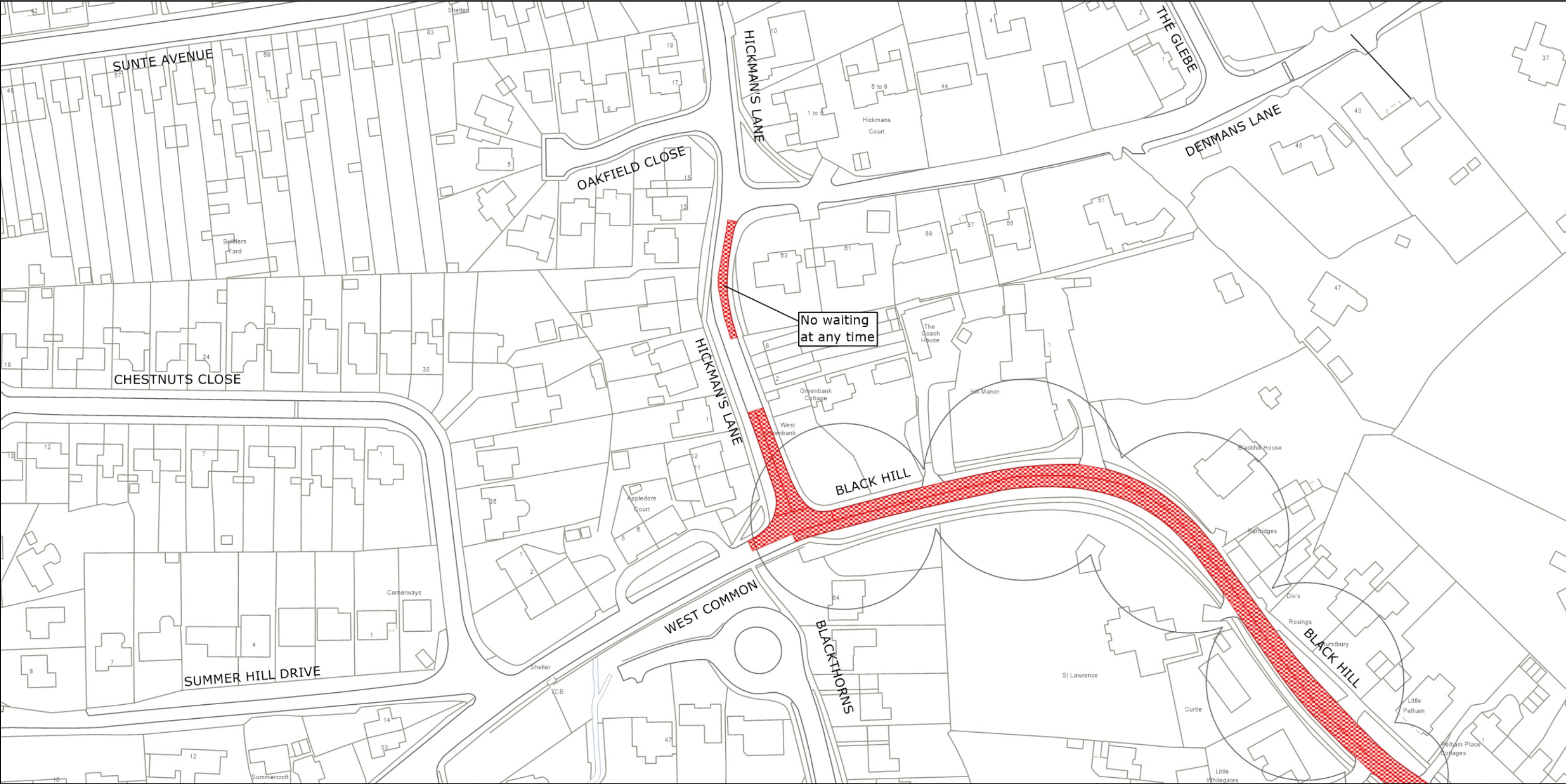

West Sussex County Council
 Highways & Transport
 The Grange
 Tower Street
 Chichester
 West Sussex
 PO19 1RH

MID SUSSEX DISTRICT: LINDFIELD
 PROPOSED WAITING RESTRICTIONS (20.01.2023)

TILE REF NO:
TQ3425SWN
 SHEET ISSUE NO 3_CMS2205
 SHEET ACTIVE FROM - DD.MM.YYYY

N

 SCALE:
 1:1250
 at A3 size

Reproduced from or based upon 2023 Ordnance Survey mapping with permission of the Controller of HMSO (c) Crown Copyright reserved. Unauthorised reproduction infringes Crown copyright and may lead to prosecution or civil proceedings West Sussex County Council Licence No. 100018485

PAGE 1 OF 2: EXISTING RESTRICTIONS ONLY



West Sussex County Council
 Highways & Transport
 The Grange
 Tower Street
 Chichester
 West Sussex
 PO19 1RH

MID SUSSEX DISTRICT: LINDFIELD
 WAITING RESTRICTIONS

TILE REF NO:
 TQ3425SWS

SHEET ISSUE NO 2
 SHEET ACTIVE FROM - 30/09/2019



SCALE:
 1:1250
 at A3 size

Reproduced from or based upon 2019 Ordnance Survey mapping with permission of the Controller of HMSO (c) Crown Copyright reserved.
 Unauthorised reproduction infringes Crown copyright and may lead to prosecution or civil proceedings West Sussex County Council Licence No. 100018485

PAGE 2 OF 2: PROPOSED CHANGES TO RESTRICTIONS (CIRCLED)

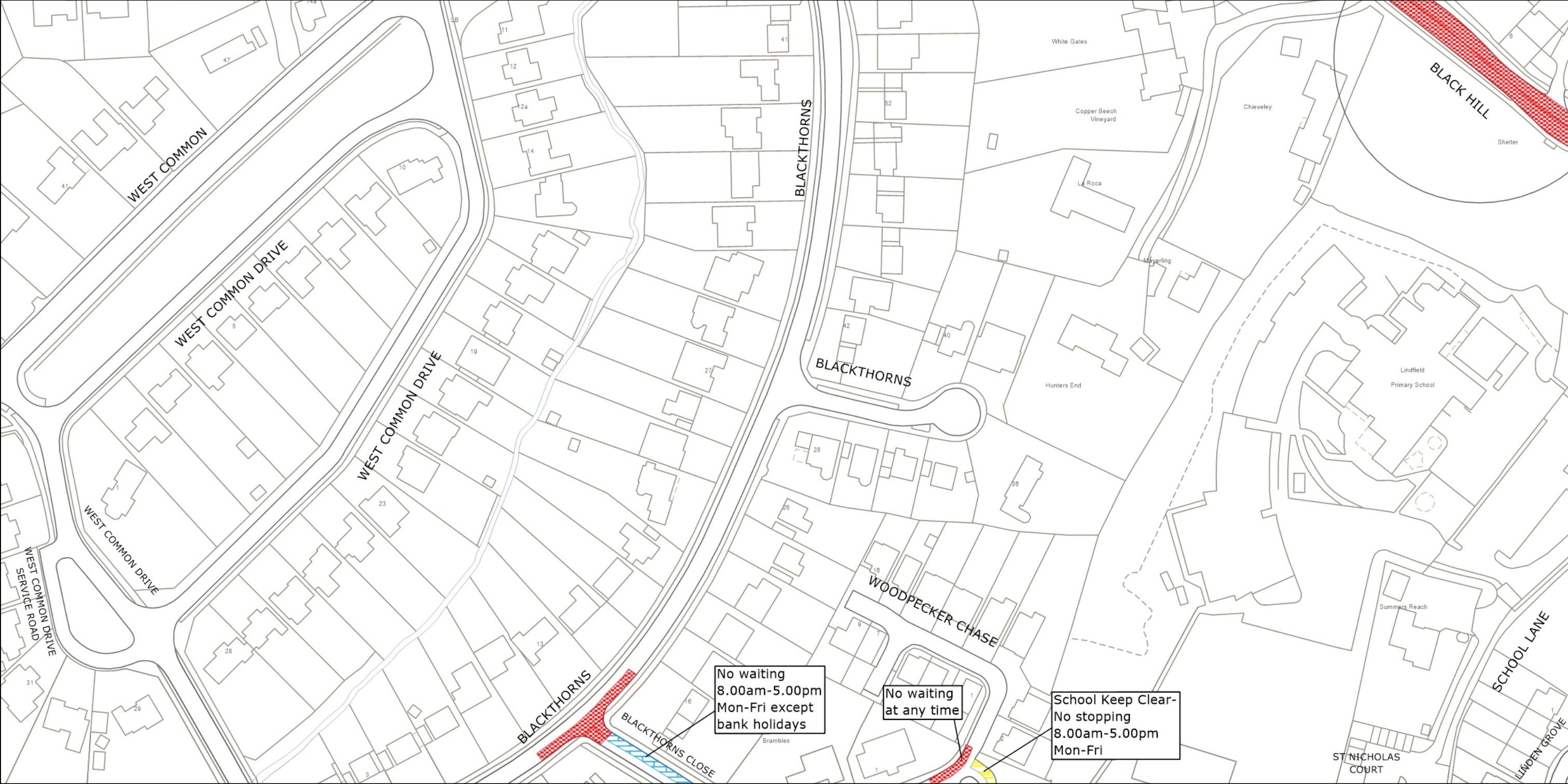

West Sussex County Council
 Highways & Transport
 The Grange
 Tower Street
 Chichester
 West Sussex
 PO19 1RH

MID SUSSEX DISTRICT: LINDFIELD
 PROPOSED WAITING RESTRICTIONS (20.01.2023)

TILE REF NO:
TQ3425SWS
 SHEET ISSUE NO 3_CMS2205
 SHEET ACTIVE FROM - DD.MM.YYYY

N

 SCALE:
 1:1250
 at A3 size

Reproduced from or based upon 2023 Ordnance Survey mapping with permission of the Controller of HMSO (c) Crown Copyright reserved. Unauthorised reproduction infringes Crown copyright and may lead to prosecution or civil proceedings West Sussex County Council Licence No. 100018485